

9.7" HD LED Monitor

This 9.7" commercial-grade monitor features the latest screen imaging technology for enhanced clarity and sharpness. Both analog and digital video will benefit by being viewed on this monitor, and it is the best match for displaying higher resolution megapixel imagery.



Specifications	
Model	A09M1/M2-4D
Mount	Rack mount Yes for A09M2-4D
HD Compatible	Yes
Anti Glare Coating	Optional
Selectable Color Temp.	Yes
Case	Metal
Native Aspect Ratio	4:3
Visible Screen Size (WH)	197.6 x 148.8mm / 7.8" x 5.9"
Resolution	1024(H) x 768(V) dots
Brightness Rating	400 cd/m ² (Nit)
Contrast Ratio	1000:1
Back Light	LED (30K)
PC Compatibility	Yes
Dot Pitch	0.192 (H) x 0.192 (V)mm
Colors	262,144
Number of Pixels	786,432
Response Time	2ms/2ms (Rising/Falling)
Viewing Angle (L/R/T/B)	89/89/89/89 degrees
Pixel Configuration	RGB Vertical Stripe
Input Signal Level	1.0V P-P (positive) 75 Ohm
3D Comb Filter	3D interlace & DNR, 4H filter
Dimensions	479 x 221.4 x 47/18.9" x 8.72"x 1.85", 5RU
Operating Temp/Humidity	32 ~ 104°F or 0 ~ 40°C
Power Requirements	12VDC, 2A, negative ground
Power Consumption	15W (A09M1-4D) / 30W (A09M2-4D) (max)
Composite	BNC IN/OUT jacks x 2 (4)
PC	15-pin mini D-sub
HDMI	Yes
Audio	Yes
Power	2.1mm DC IN jack

Features

- Displays HD signals (1080i/p)
- LED backlight for better color, longer-life, and lower power
- Wide viewing angle (89/89/89/89)
- Multiple connections including 2x BNC Input / Output for looping
- Excellent contrast ratio
- Image enhancing - 3D Interlace comb filter, DNR, 4H filter
- Durable metal case

9.7" Standalone photo frame type I (A09M1-4D)

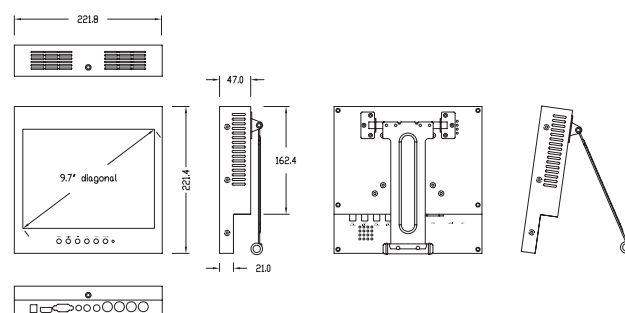

9.7" Dual-display type (A09M2-4D)

